

COPY

Summary of Significant Changes at this Revision

Amendment of recommended time to delivery sample

<p>Purpose and Scope</p> <p>Information for GPs on referring patients for fertility analysis. Includes copy of instructions for production of sample and site map</p>	<p>Items Required</p>
<p>Definitions and Abbreviations</p>	<p>Grade / Qualifications Required</p>

Semen Samples for Fertility Analysis – Information for GPs

1. These tests are carried out by appointment and are available Tuesdays and Thursdays only. The patient should telephone the Cytology Laboratory office (01225 824721) to make the appointment and should bring the sample to the laboratory on the day of the appointment in sufficient time that it may be analysed within one hour of production. We advise that the sample is delivered within 50 minutes of production to allow for this.

Samples received later than 50 minutes will be analysed, but sperm motility values may be compromised.

2. Please note **there are no facilities** for production of a specimen at the laboratory.

Therefore a sample kit will be dispatched to the surgery after the patient has booked his appointment. The kit comprises:-

- Instruction sheet for collecting the sample
- White Histology/ Cytology request form - **Please fill request details and ask patient to complete supplementary information after producing sample.**
- White capped plastic specimen pot. These containers have been **batch tested for sperm toxicity.**

3. The patient is advised to collect the sample directly into the specimen container by masturbation. Occasionally this proves to be difficult for the patient (for example due to religious beliefs). In these instances the patient may be advised to use a non-spermicidal condom (available online) and collect the sample following intercourse. **If such method is used please state on the request form.**

Royal United Hospitals Bath



NHS Foundation Trust

DIRECTORATE OF PATHOLOGY

Please reply to Cytology Department

Direct Line 01225 824721

INSTRUCTIONS FOR THE COLLECTION OF SEMEN FOR FERTILITY ANALYSIS

1. Telephone the Laboratory on **01225 824721** between **8:30am and 3pm** to arrange an appointment for analysis of your sample and for a sample kit to be dispatched to your surgery for you to collect. Please note **there are no facilities** for production of a specimen at the laboratory.
2. Refrain from sexual activity including masturbation for 48 hours – 7 days before the test, but try not to leave it any longer because this can decrease sperm motility.
3. Before producing your sample please wash your hands and penis carefully. The specimen must be produced by masturbation directly into the container provided (a condom or lubricant must not be used). The whole of the specimen is needed and care should be taken not to lose any.
4. If you feel unable to produce a sample by masturbation please speak to your clinician who should be able to provide advice. You may be advised to purchase a non-spermicidal condom and collect the sample following intercourse. **If such method is used please state on the request form.**
5. After collection replace screw cap, making sure it is tightly closed and **write your name and date of birth on the label along with the date and time of collection**. Check that this information is also on the request form. **SAMPLES WHICH ARE NOT LABELLED WILL NOT BE ANALYSED**
6. The specimen must be produced and brought to the laboratory within 50 minutes of production. Samples received later than this will be analysed but consequently some results may be less accurate. Keep specimen warm – trouser pocket is ideal.

INSTRUCTIONS FOR DROPPING OFF SEMEN SAMPLES

1. Please make your way to the Pathology Department using the map provided. Follow red arrows to dedicated 'Drop-off and Pick-up' parking spaces (do not use the disabled spaces unless you are a blue badge holder).
2. 20 minutes of parking time allowed here; however, in the event that none of these spaces are available, please use one of the visitors car-parks (P1 or P2) where you will be required to pay.
3. The Pathology Laboratory is a short walk from drop-off car park. Follow the yellow arrows on map passing the entrance to zone B on your left, cross the next road and the building is immediately on your left.
4. Please enter the building as shown in the photo below.
5. Use the intercom to contact Specimen Reception and the door will be released for you to enter the department. Please make your way to the staircase situated to the right and walk up to the first floor. At the first floor entrance to specimen reception please press the bell on the right. A member of staff will meet you to check your details and accept the specimen.

Please note that the laboratory can not guarantee that parking spaces will be available in the 'Drop-off and Pick-up' zone at the time of your appointment. Please try to allow enough time should parking be difficult.

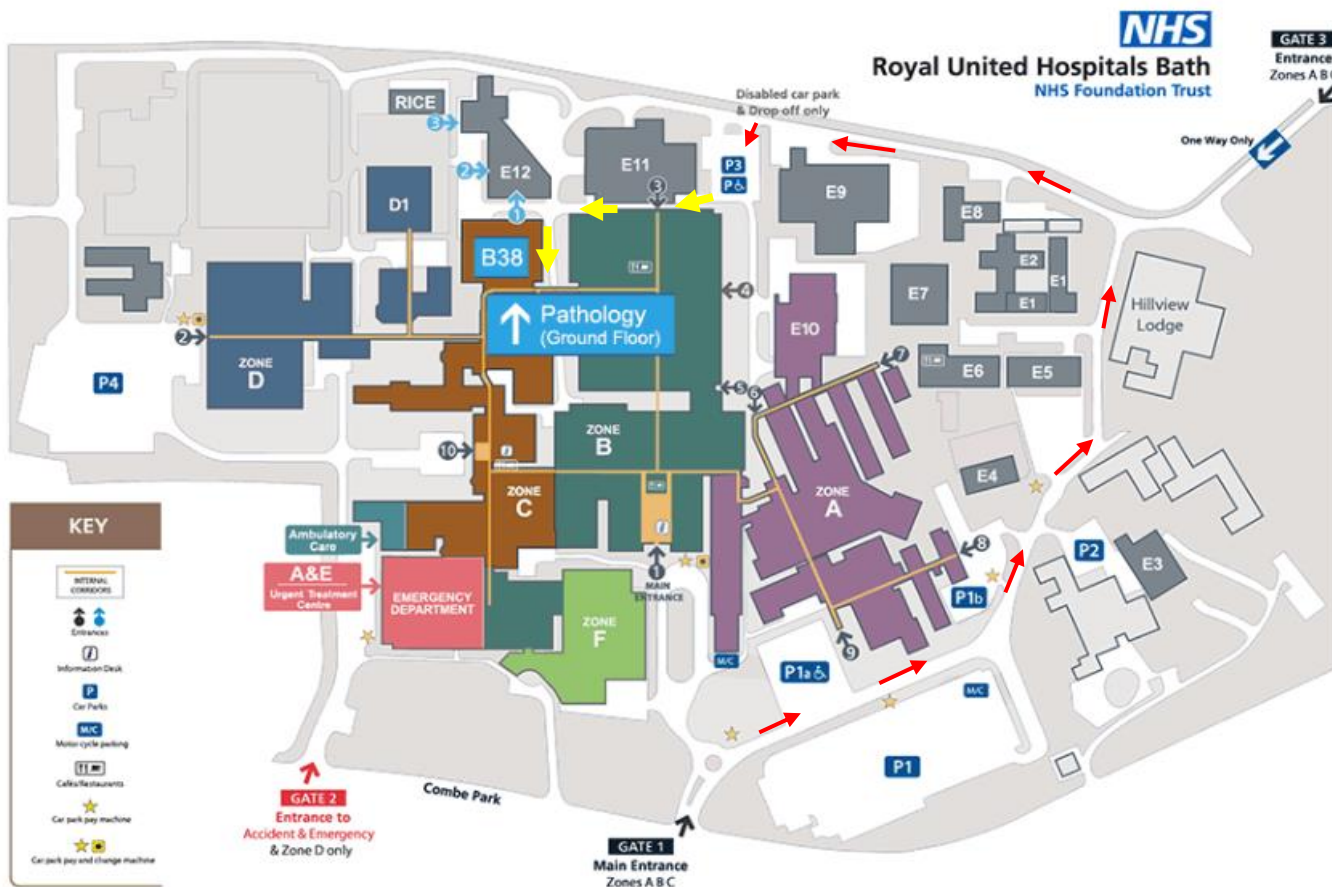

Printed copies are uncontrolled unless there is an allocated Copy Number on page 1



Copy number	Location held
1	Cytology Office
2	Andrology SOP Folder
3	Electronic copy – RUH Website

Printed copies are uncontrolled unless there is an allocated Copy Number on page 1